

\* CY/CM14-1D外形尺寸见下列图表:

尺寸	规格																													
	螺纹连接								法兰连接																					
	10*		25*		40*		63*/80*		160*		250*																			
轴端分类	大轴	小轴	大轴	小轴	大轴	小轴	大轴	小轴	大轴	小轴	大轴	小轴																		
A	φ 30h6	φ 20h6	φ 30h6	φ 20h6	φ 30h6	φ 20h6	φ 40h6	φ 30h6	φ 50h6	φ 40h6	φ 50h6	φ 40h6																		
B	φ 100	φ 80	φ 100	φ 80	φ 100	φ 80	φ 125	φ 100	φ 160	φ 125	φ 160	φ 125																		
C	32.5	22.5	32.5	22.5	32.5	22.5	42.8	32.5	53.8	42.8	53.8	42.8																		
D	44	31	45	32	45	32	60	46	90	60	90	60																		
E	4		4		4		4		4		5																			
F	40	28	40	28	40	28	50	40	80	55	80	55																		
G	7		7		9		9		9		9																			
H	175		175		200		224		280		355																			
I	16		20		20		22		28		32																			
J	45		45		45		53		63		81																			
K	130		157		145		196		244		321																			
L	71		83		87		108		145		170																			
M	M14×1.5-7H		M14×1.5-7H		M18×1.5-7H		M18×1.5-7H		M22×1.5-7H		M22×1.5-7H																			
N	140		140		140		180		224		280																			
P	14		14		14		18		22		26																			
Q	8h9	6h9	8h9	6h9	8h9	6h9	12h9	8h9	16h9	12h9	16h9	12h9																		
R	-		-		-		-		40		45																			
S	142		172		180		200		260		330																			
T	M22×1.5-7H		M33×2-7H		M39×2-7H		M42×2-7H (63*) M48×2-7H (80*)		Φ50 (1000r/min) Φ55 (1500r/min)		Φ55 (1000r/min) Φ65 (1500r/min)																			
U	-		-		-		-		Φ64 (1000r/min) Φ70 (1500r/min)		Φ76 (1000r/min) Φ76 (1500r/min)																			
V	-		-		-		-		90		110																			
W	-		-		-		-		25		25																			
X	234		277		287		341		435		518																			
Y	194		228		226		286		353		445																			
AA	φ 150		φ 170		φ 182		φ 225		φ 300		φ 360																			
BB	189		219		220		281		349		441																			
CC	23.4		36.4		29		43.4		42.8		57																			
DD	M6-6g		M8-6g		M8-6g		M8-6g		M8-6g		M8-6g																			
EE	105	97	88	130	100	140	127	102	159	130	138	133	138	168	133	157	160	130	180	155	180	178	167	/	177	215	215	203	/	207
FF	242	289	231	287	276	320	352	263	339	298	336	349	296	344	302	354	397	306	377	365	399	453	405	/	421	461	522	465	/	518
变量形式	C	Y	S	MY	P	C	Y	S	MY	P	C	Y	S	MY	P	C	Y	S	MY	P	C	Y	S	MY	P	C	Y	S	MY	P

备注: ① 5MCY14-1D柱塞泵相关尺寸请联系我司技术部。

② 因不同功率的插入式电机其轴孔大小不一样, 选泵时请注意同一规格排量的D型泵有大轴和小轴区分。

③ 因插入式电机是专用电机, 为非标产品, 以上型号规格尺寸仅供参考(请以实物为准), 如有变动, 恕不另行通知。

# MCY14-1D轴向柱塞泵外形尺寸

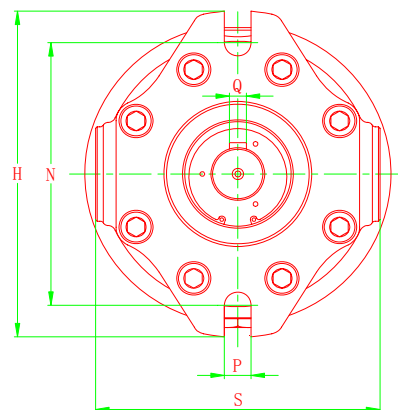
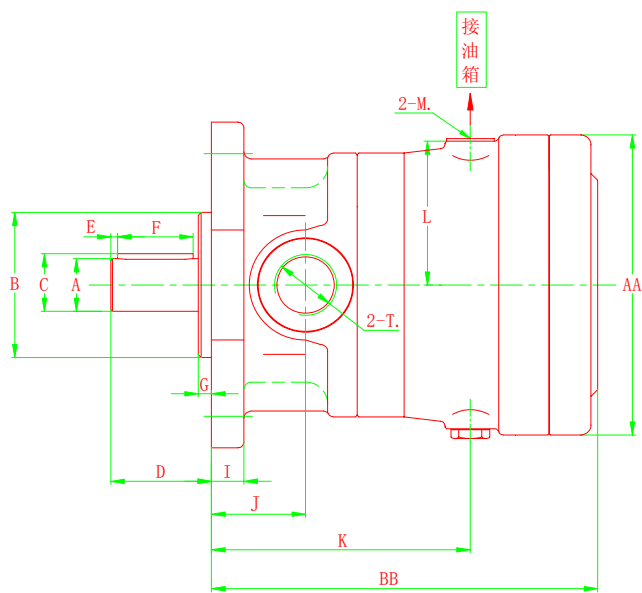

↑ 螺纹连接

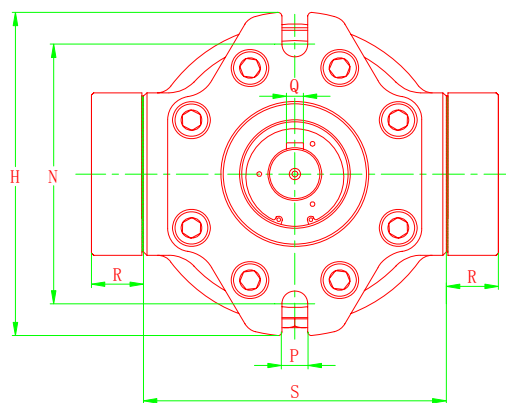
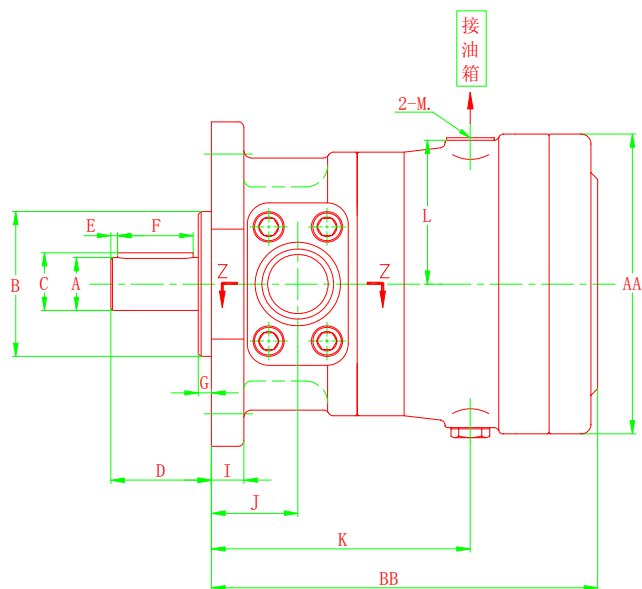

Z-Z

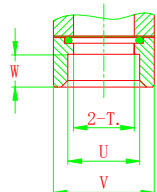

↑ 法兰连接

# CCY14-1D轴向柱塞泵外形尺寸

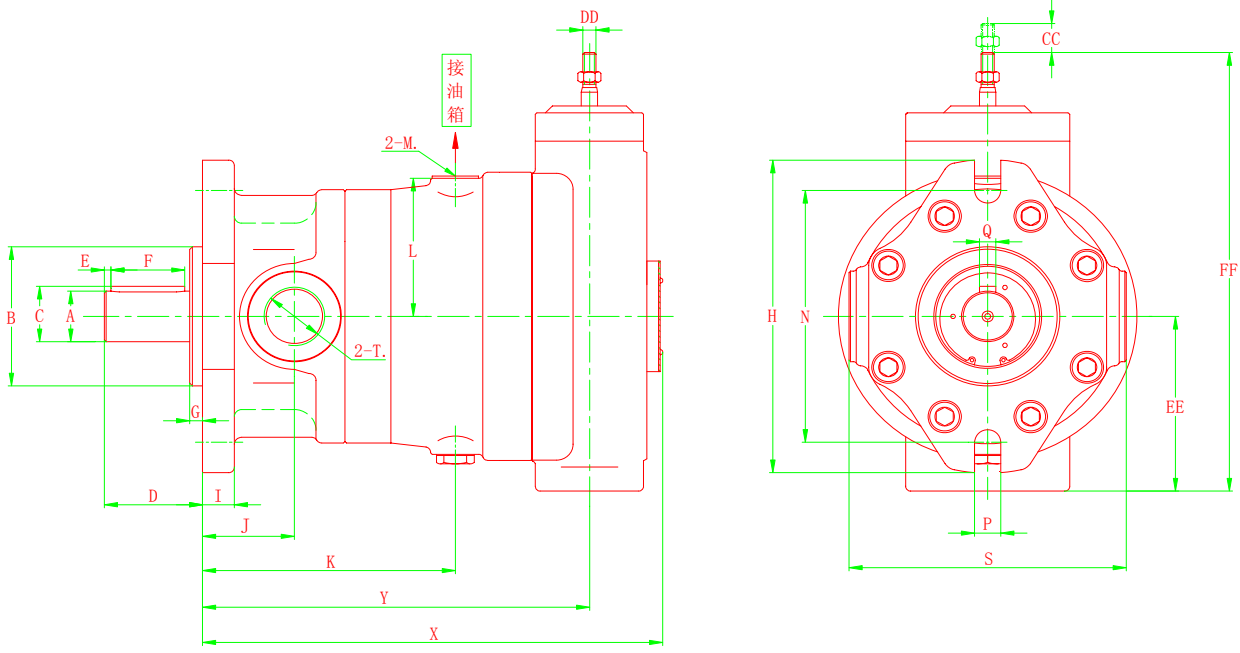

↑ 螺纹连接

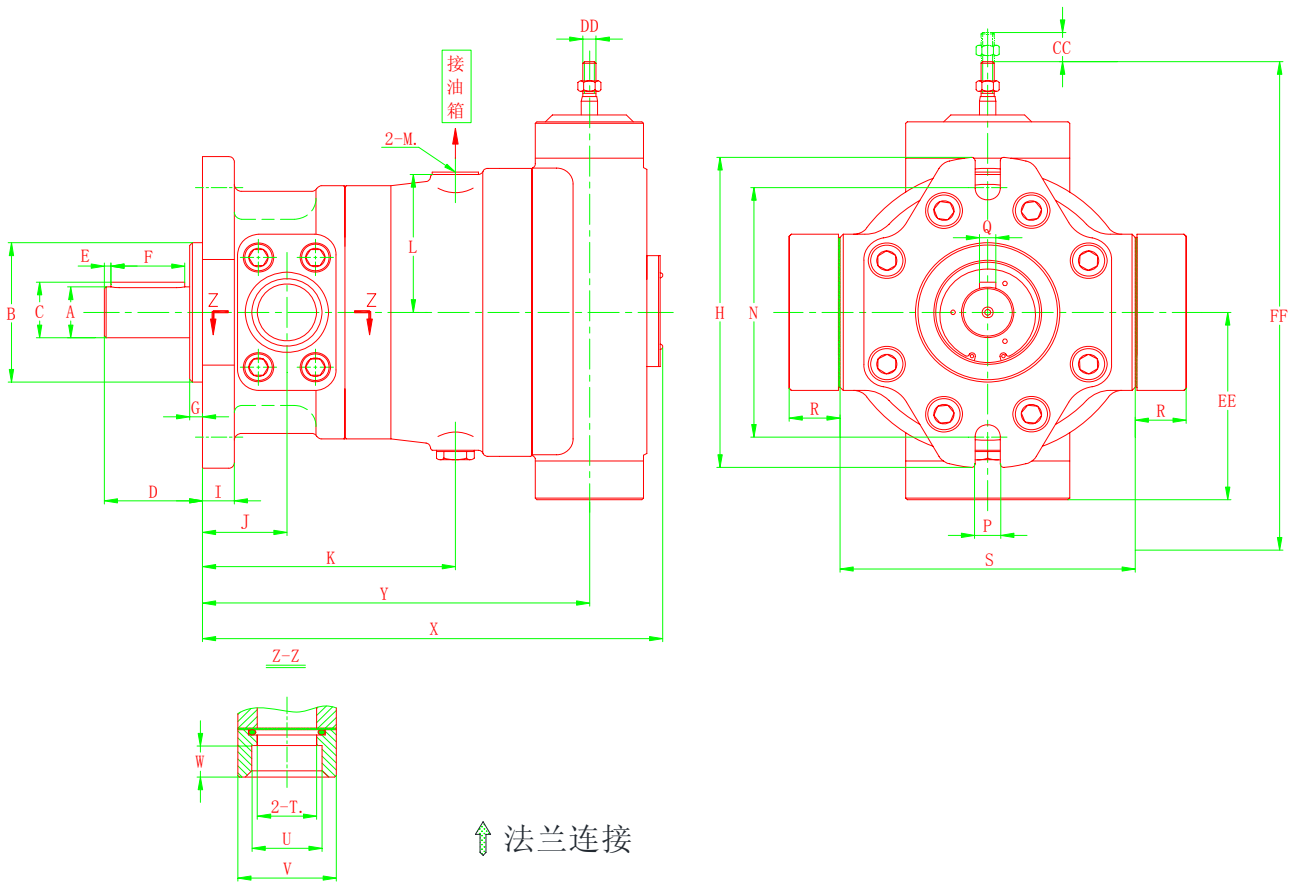

↑ 法兰连接

# MY CY14-1D轴向柱塞泵外形尺寸

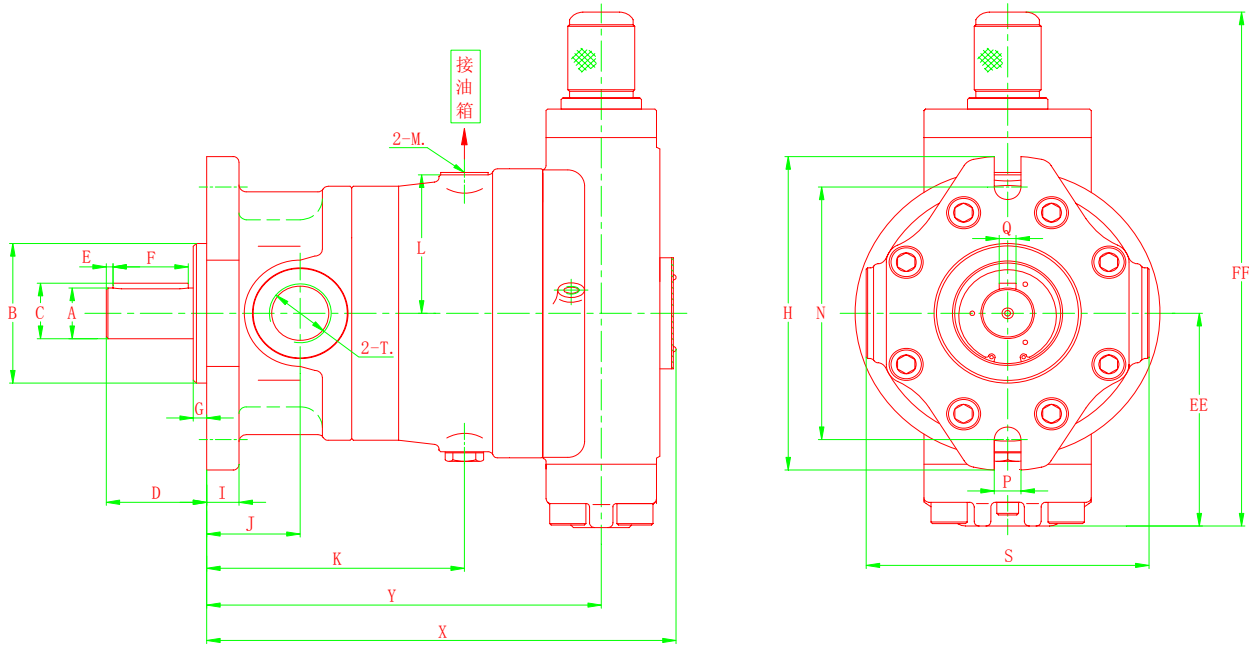

↑ 螺纹连接

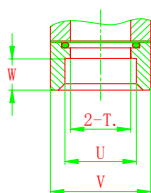
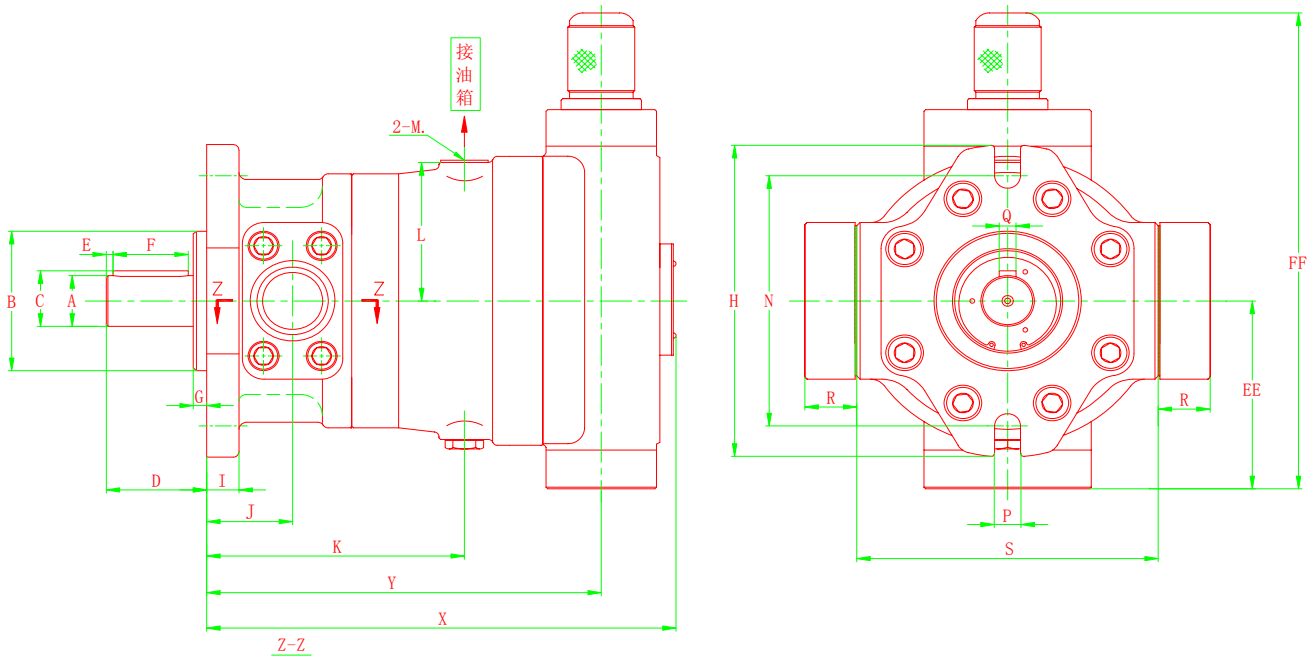

↑ 法兰连接

# SCY14-1D轴向柱塞泵外形尺寸

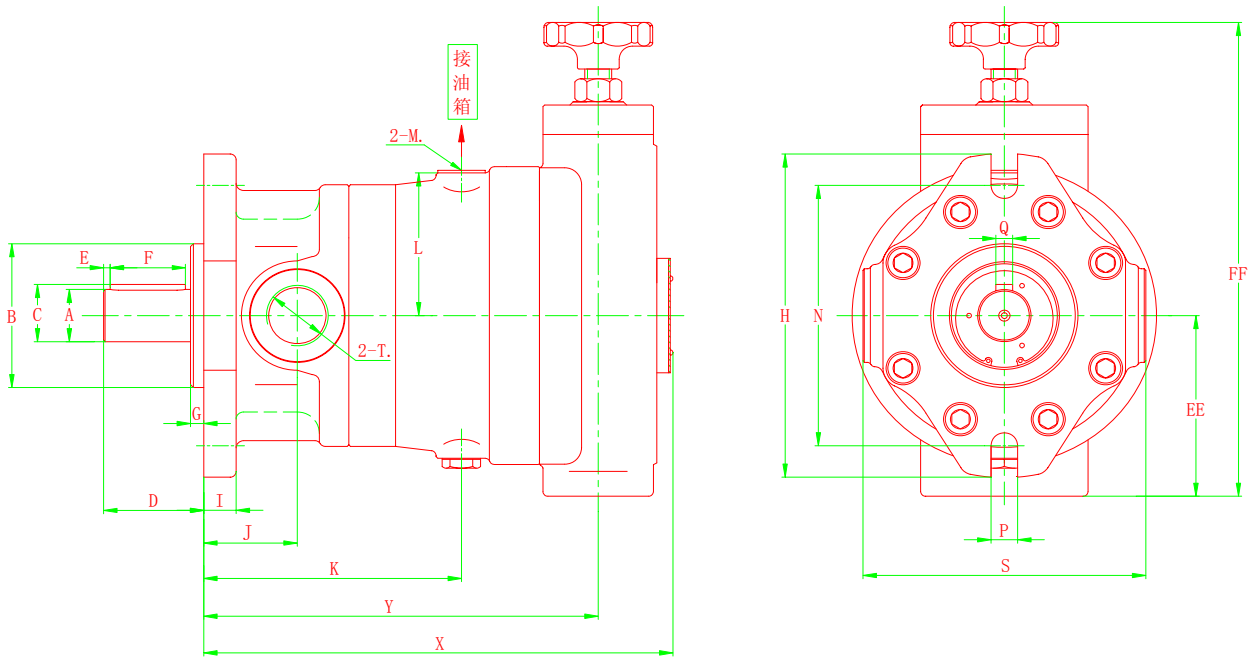

↑ 螺纹连接

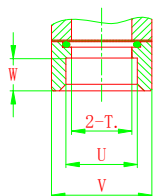
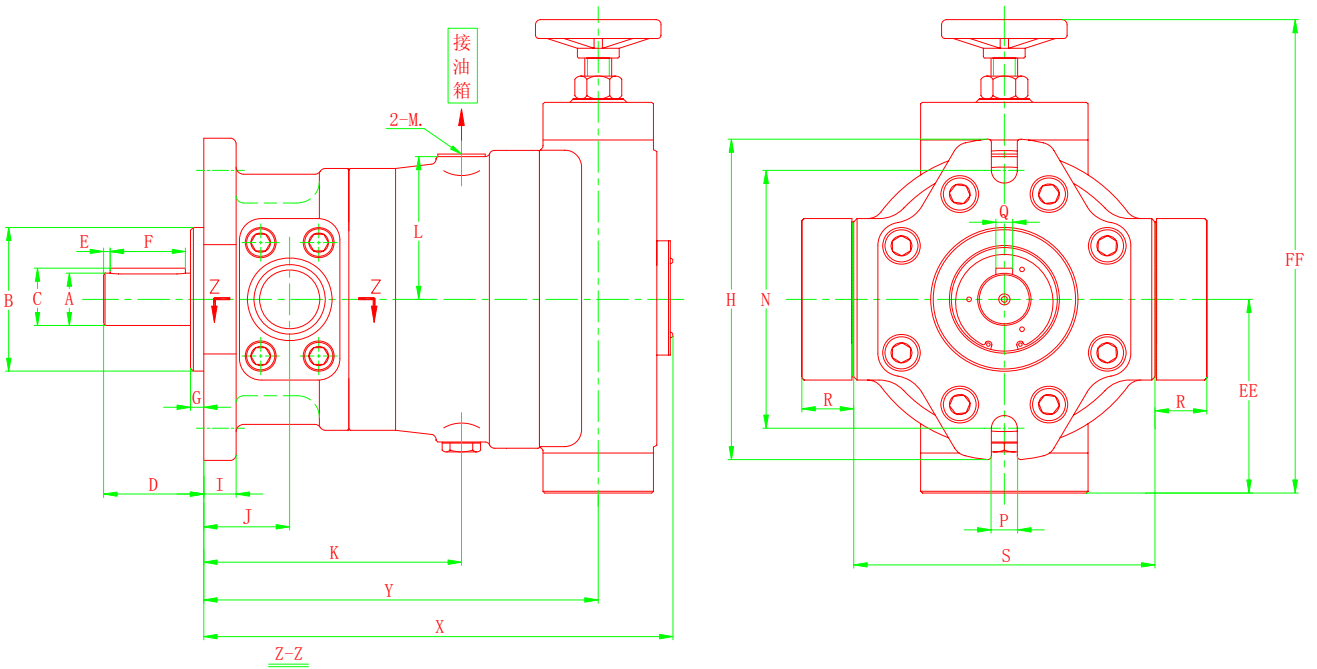

↑ 法兰连接

# PCY14-1D轴向柱塞泵外形尺寸

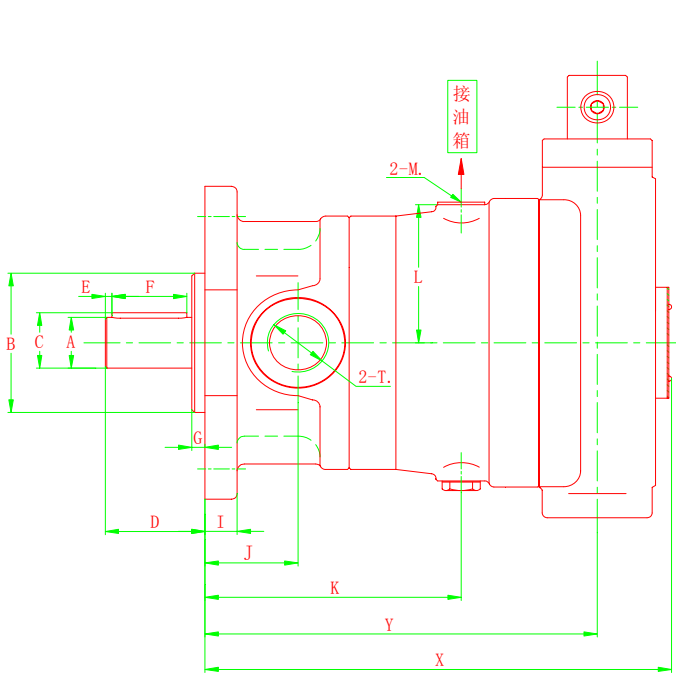

↑ 螺纹连接

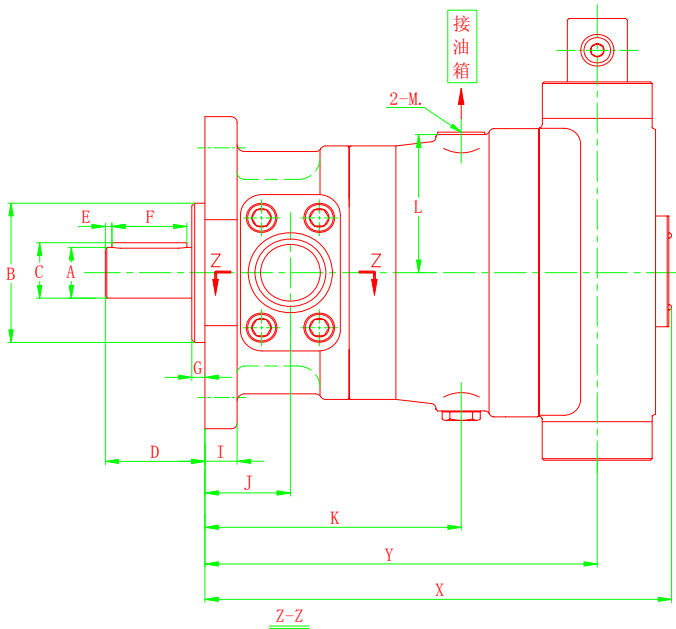
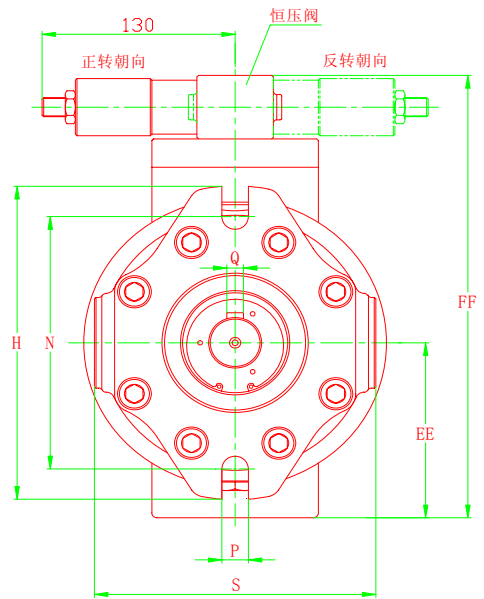

Z-Z

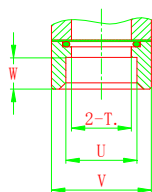
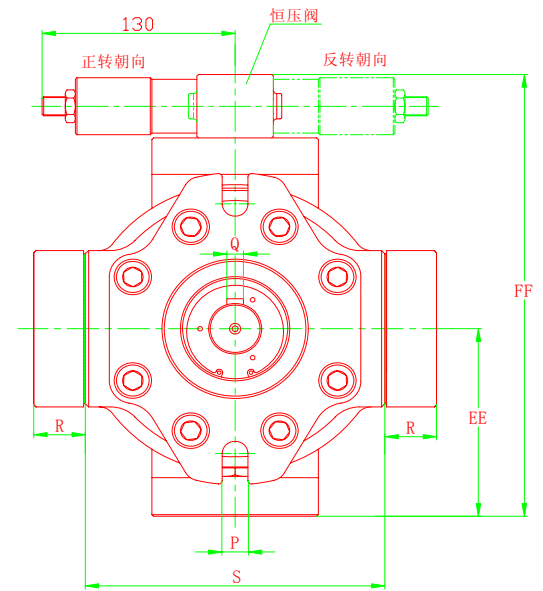

↑ 法兰连接